

TRACT 404  
STONEYBROOK GOLF AND COUNTRY CLUB

STONEYBROOK GOLF &  
COUNTRY CLUB UNIT 1

**DEMOLITION NOTES:**  
1. ALL TREES TO REMAIN WILL BE PROTECTED WITH TREE BARRICADES.

John K. Pari, State of Florida, Professional Engineer, License No. 56368;  
This item has been digitally signed and sealed by John K. Pari, P.E. on the date indicated here. Signature must be verified on any electronic copies.

REV. No.	REV. DATE	REVISION DESCRIPTION	BY	REV. No.	REV. DATE	REVISION DESCRIPTION	BY
1	10.17.25	ADDENDUM 01					

CALL BEFORE YOU DIG!  
"SUNSHINE STATE ONE-CALL CENTER"  
1-800-432-4770  
THE CONTRACTOR SHALL NOTIFY "SUNSHINE STATE ONE-CALL CENTER" AND ALL OTHER UTILITIES FOR LOCATION OF EXISTING FACILITIES PRIOR TO BEGINNING CONSTRUCTION.  
ISSUE DATE: **8/05/2025**  
ISSUE DESCRIPTION: **CONSTRUCTION PLAN**

Civil Engineering | Land Surveying  
**AM ENGINEERING, LLC.**  
8340 Consumer Court Sarasota, FL 34240  
Phone: (941) 377-9178 | www.amengll.com  
CA #33105 | LB #4334

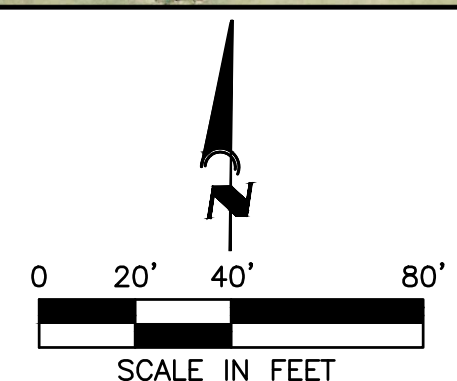

PROJECT: **STONEYBROOK GOLF & COUNTRY CLUB**  
SUBJECT: **CLUBHOUSE- FITNESS CENTER RENOVATIONS, TENNIS CT. & NEW PICKLEBALL CT.**  
DATE: **EXISTING CONDITONS/DEMOLITION PLAN**

HORIZONTAL SCALE:	1"=40'
VERTICAL SCALE:	N/A
VERTICAL DATUM:	NGVD 29
PROJECT NUMBER:	STBR0001
SHEET NUMBER:	3

PROJECT ENGINEER:  
**JOHN K. PARI, PE**  
DATE: \_\_\_\_\_  
FLORIDA P.E. No. 56368

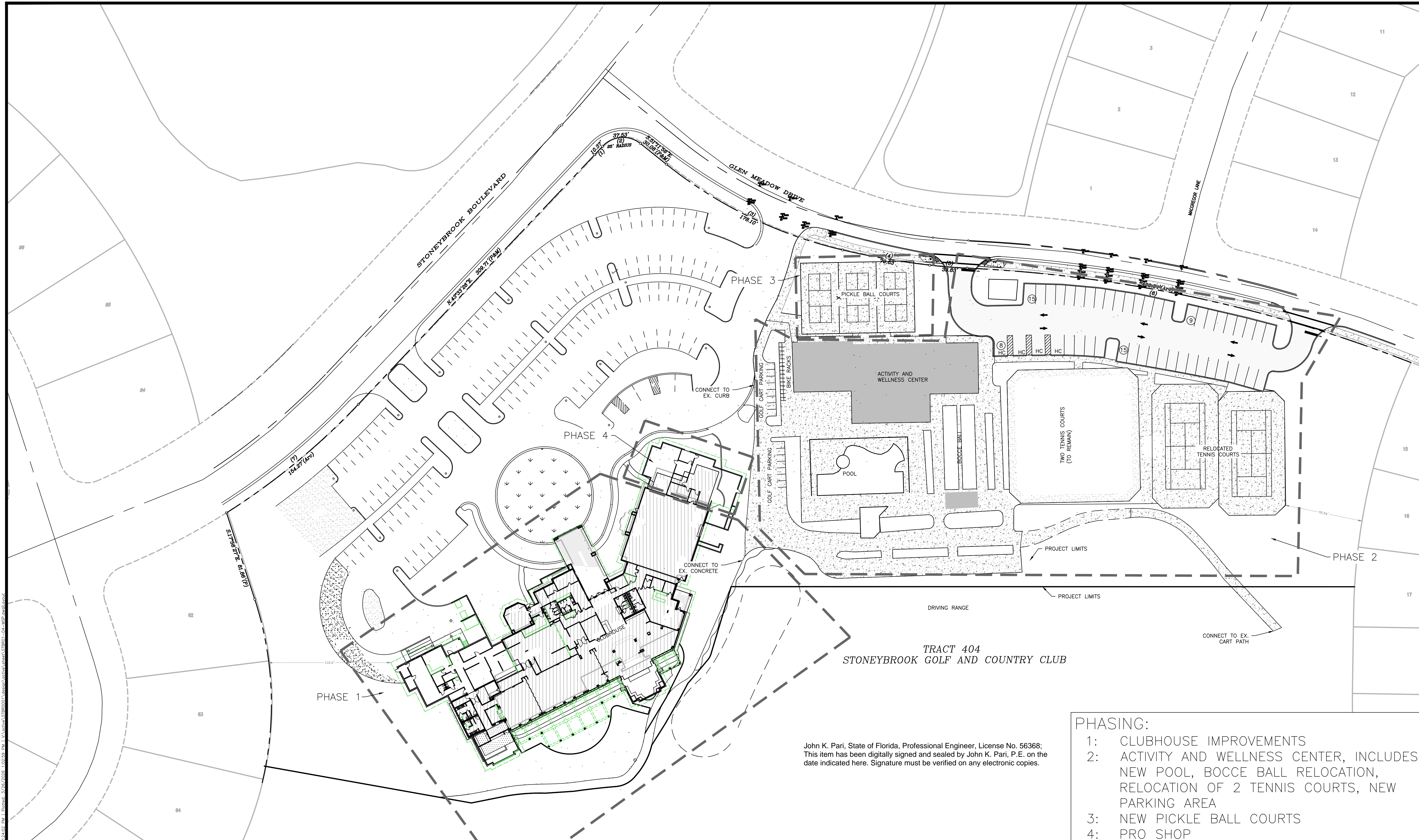

John K. Pari, State of Florida, Professional Engineer, License No. 56368;  
 This item has been digitally signed and sealed by John K. Pari, P.E. on the  
 date indicated here. Signature must be verified on any electronic copies.

- PHASING:**
- 1: CLUBHOUSE IMPROVEMENTS
  - 2: ACTIVITY AND WELLNESS CENTER, INCLUDES NEW POOL, BOCCÉ BALL RELOCATION, RELOCATION OF 2 TENNIS COURTS, NEW PARKING AREA
  - 3: NEW PICKLE BALL COURTS
  - 4: PRO SHOP

REV. No.	REV. DATE	REVISION DESCRIPTION	BY	REV. No.	REV. DATE	REVISION DESCRIPTION	BY
1	10.17.25	ADDENDUM 01					

CALL BEFORE YOU DIG!  
 "SUNSHINE STATE ONE-CALL CENTER"  
 1-800-432-4770  
 THE CONTRACTOR SHALL NOTIFY "SUNSHINE STATE ONE-CALL CENTER" AND ALL OTHER UTILITIES FOR LOCATION OF EXISTING FACILITIES PRIOR TO BEGINNING CONSTRUCTION.  
 ISSUE DATE: 8/05/2025  
 ISSUED BY: WP  
**CONSTRUCTION PLANS**

Civil Engineering | Land Surveying

**AM ENGINEERING, LLC.**

8340 Consumer Court Sarasota, FL 34240  
 Phone: (941) 377-9178 | www.amengll.com  
 CA #33105 | LB #4334

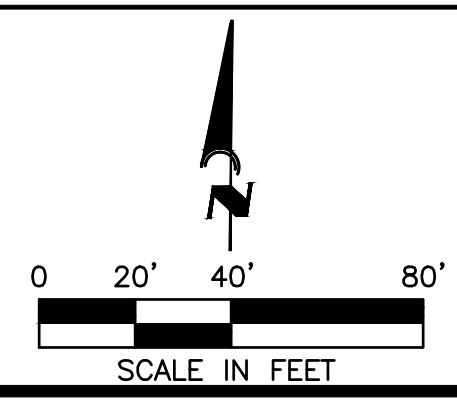

PROJECT: **STONEYBROOK GOLF & COUNTRY CLUB**

SUBJECT: **CLUBHOUSE-FITNESS CENTER RENOVATIONS, TENNIS CT. & NEW PICKLEBALL CT.**

TITLE: **MASTER SITE PLAN**

HORIZONTAL SCALE:	1" = 40'
VERTICAL SCALE:	N/A
VERTICAL DATUM:	NGVD 29
PROJECT NUMBER:	STBR0001
SHEET NUMBER:	4

PROJECT ENGINEER: JOHN K. PARI, PE  
 DATE: \_\_\_\_\_  
 FLORIDA P.E. No. 56368



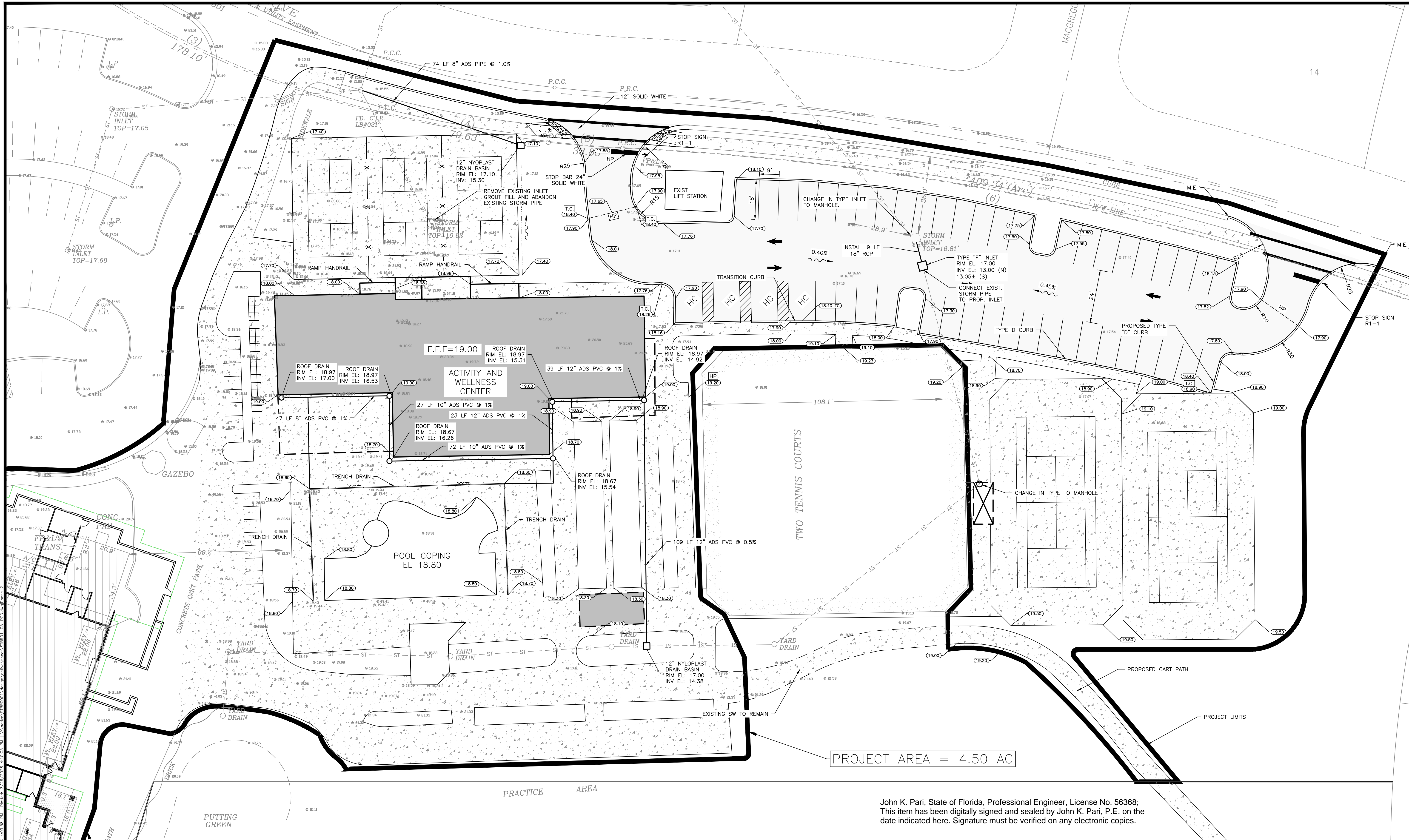

PROJECT AREA = 4.50 AC

John K. Pari, State of Florida, Professional Engineer, License No. 56368;  
 This item has been digitally signed and sealed by John K. Pari, P.E. on the  
 date indicated here. Signature must be verified on any electronic copies.

REV. No.	REV. DATE	REVISION DESCRIPTION	BY	REV. No.	REV. DATE	REVISION DESCRIPTION	BY
1	10.17.25	ADDENDUM 01					

CALL BEFORE YOU DIG!  
 "SUNSHINE STATE ONE-CALL CENTER"  
 1-800-432-4770  
 THE CONTRACTOR SHALL NOTIFY "SUNSHINE STATE ONE-CALL CENTER" AND ALL OTHER UTILITIES FOR LOCATION OF EXISTING FACILITIES PRIOR TO BEGINNING CONSTRUCTION.  
 ISSUE DATE: 8/05/2025  
 ISSUE DESCRIPTION: WP  
**CONSTRUCTION PLNS**

Civil Engineering | Land Surveying

**AM ENGINEERING, LLC.**  
 8340 Consumer Court Sarasota, FL 34240  
 Phone: (941) 377-9178 | www.amengll.com  
 CA #33105 | LB #4334

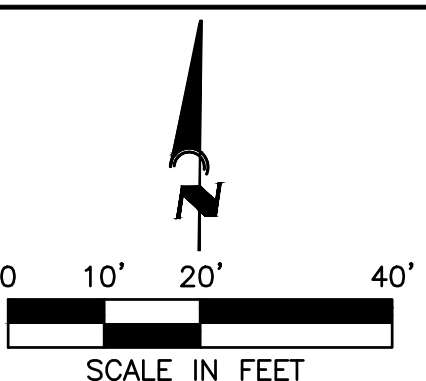

PROJECT: **STONEBROOK GOLF & COUNTRY CLUB**  
 SUBJECT: **CLUBHOUSE-FITNESS CENTER RENOVATIONS, TENNIS CT. & NEW PICKLEBALL CT.**  
 DATE: **PAVING, GRADING & DRAINAGE PLAN PHASES 2 AND 3**

HORIZONTAL SCALE:	1"=20'
VERTICAL SCALE:	N/A
VERTICAL DATUM:	NGVD 29
PROJECT NUMBER:	STBR0001
SHEET NUMBER:	6

JOHN K. PARI, PE  
 DATE: \_\_\_\_\_  
 FLORIDA P.E. No. 56368

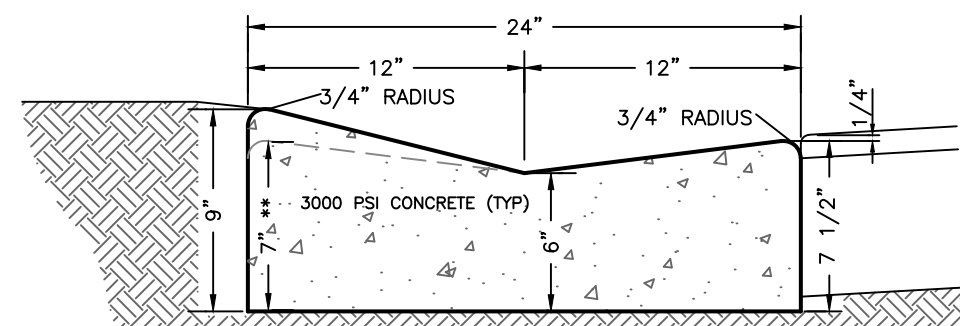

\*\* DROP BACK OF CURB 2" AT SIDEWALK CONNECTIONS

**TYPE "M" CURB**

CURBS SHALL BE POURED IN ONE HOMOGENEOUS/MONOLITHIC POUR. FOR CURBS, GUTTER AND CURB AND GUTTER PROVIDE 1/8"-1/4" CONTRACTION JOINTS AT 10' CENTERS (MAX.) PER FDOT INDEX 300 CURB, GUTTER AND CURB AND GUTTER EXPANSION JOINTS SHALL BE LOCATED IN ACCORDANCE SECTION 520 OF THE FDOT "STANDARD SPECIFICATIONS", INDEX NO. 300 OF THE "ROADWAY AND TRAFFIC DESIGN STANDARDS". FOR ADDITIONAL DETAILS, REFER TO FDOT.

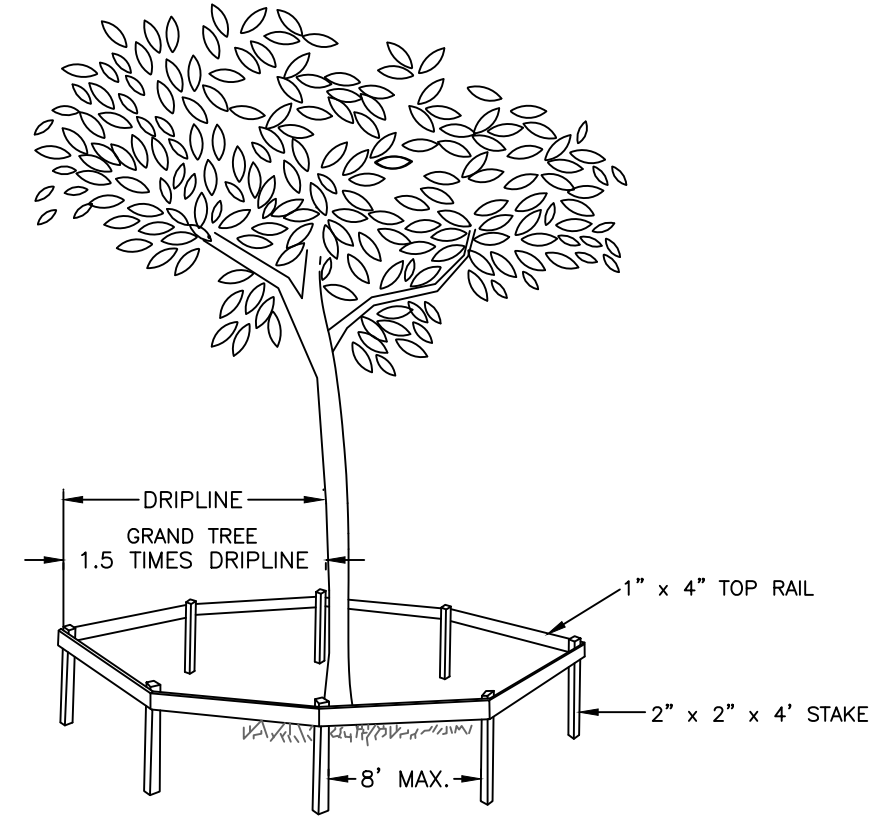

FOR GRAND TREE BARRICADES: A SIGN SHALL BE INSTALLED AT THE EDGE OF EACH GRAND TREE BARRICADE STATING "NO ACTIVITIES ARE ALLOWED WITHIN BARRICADE AREA, UNLESS APPROVED BY THE COUNTY". CONTRACTOR SHALL REVIEW SARASOTA COUNTY CODE, SECTION 54-588 FOR ADDITIONAL GRAND TREE REQUIREMENTS.

**TREE BARRICADE DETAIL**

**NOTE:**

PURSUANT TO THE TREE PROTECTION PROGRAM, SARASOTA COUNTY CODE, SECTION 54-588, TREE PROTECTION BARRICADES WILL BE CONSTRUCTED OF ALL WOOD MATERIAL IN A POST AND RAIL TYPE CONFIGURATION (SEE EXAMPLE ABOVE). HIGH VISIBILITY, HEAVY GAUGE TAPE MAY BE SUBSTITUTED FOR THE 1" x 4" CONNECTING BOARDS. THE BARRICADE TAPE MUST BE A MINIMUM OF THREE (3) INCHES WIDE, AND 7-MIL REINFORCED POLYETHYLENE CONSTRUCTION, AND BE A HIGHLY VISIBLE COLOR. STRING AND RIBBON WILL ONLY BE ACCEPTED FOR BARRICADING AREAS SUCH AS RIGHT-OF-WAYS, GOLF COURSES, DRIVEWAYS OF 100 FEET OR MORE, LAKES OR RETENTION AREAS. BARRICADES MUST BE PLACED A MINIMUM OF 6 FEET OR 1/2 THE DRIP LINE, WHICHEVER IS GREATER FROM THE TREE. FOR PALMS, BARRICADES MAY BE PLACED AS CLOSE AS THREE FEET FROM THE TRUNK. BARRICADE REQUIREMENTS FOR GRAND TREES ARE MORE STRINGENT, SEE SECTION 54-589 OF SARASOTA COUNTY CODE. FULL DRIP LINE PROTECTION IS REQUIRED FOR GRAND TREES AND RECOMMENDED FOR ALL OTHER TREES. WOOD DIMENSIONS SHOWN DENOTE LUMBER INDUSTRY STANDARD DIMENSIONS.

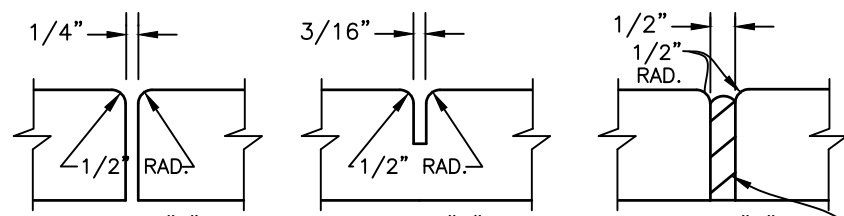

**STANDARD SIDEWALK JOINTS**

TYPE	LOCATION
A	P.C. AND P.T. OF CURVES, JUNCTION OF EXISTING AND NEW SIDEWALKS.
B	5'-0" CENTER TO CENTER ON SIDEWALKS.
C	ANYWHERE SIDEWALK ABUTS CONCRETE CURBS, DRIVEWAYS AND SIMILAR STRUCTURES. CONTINUOUS SIDEWALKS INTERNALS NOT EXCEED 100 FEET.

**SIDEWALK NOTES:**

- INSURE OFFSET FROM PROPERTY LINES MEET WITH THE APPROVED PLAN. THE MINIMUM COMPRESSIVE STRENGTH OF THE CONCRETE SHALL BE 3000 P.S.I. AT 28 DAYS.
- CONTRACTION JOINT CONSTRUCTION: SECTIONS NOT TO BE LESS THAN 4 FEET OR MORE THAN 10 FEET LONG.
- EXPANSION MATERIAL TO BE PLACED AT ALL DRIVEWAYS AND SIDEWALK INTERSECTIONS AND WHEN OPERATIONS CEASE FOR ANY CONSIDERABLE TIME. SIDEWALKS SHALL HAVE EXPANSION JOINTS AT A MAXIMUM OF 100 FEET.
- THE PITCH OF THE SIDEWALK SHALL BE NO MORE THAN ONE QUARTER INCH PER FOOT TOWARDS THE ROAD, OR AS THE APPROVED PLAN SHOWS. THE INCLINE WILL NOT BE GREATER THAN 12:1.
- SIDE SLOPES ADJACENT TO SIDEWALKS SHALL NOT EXCEED 4:1.
- SOD SHALL BE PLACED WITHIN THE COUNTY RIGHT-OF-WAY FROM BACK OF CURB TO THE FACE OF THE SIDEWALK.
- ALL ORGANIC MATERIAL AND DEBRIS SHALL BE REMOVED, AREA GRADED AND COMPACTED PRIOR TO CONCRETE PLACEMENT.

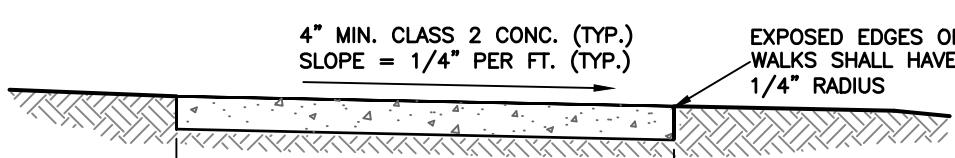

**STANDARD SIDEWALK DETAIL - ONSITE**

SEE FDOT INDEX #304 FOR SIDEWALK/CURB TRANSITION W/HANDICAP ACCESSIBILITY

- GENERAL NOTES:**
- SIDEWALKS:**
    - ALL SIDEWALKS SHALL COMPLY WITH FOOT INDICES 522-001 AND 522-002 AND BE A MINIMUM OF 5 FEET IN WIDTH AND 4 INCHES IN DEPTH WHEN NOT AT A DRIVEWAY OR WITHIN 2 FEET OF THE FACE OF CURB.
    - SIDEWALKS WITH LESS THAN 2 FEET FROM THE FACE OF A HIGH-BACK SHALL BE A MINIMUM OF 6 FEET IN WIDTH.
    - SIDEWALKS TRANSVERSING DRIVEWAYS SHALL BE A MINIMUM OF 6 INCHES IN DEPTH.
    - SIDEWALKS AND DRIVEWAYS WITHIN THE RIGHT-OF-WAY SERVING COMMERCIAL STREETS SHALL BE A MIN. 6 INCHES IN DEPTH AND INCLUDE #10 WIRE MESH OR #3 BARS AT 6 INCHES ON CENTER.
    - SIDEWALK CROSS SLOPES SHALL BE DESIGNED AT 1:5 WITH A MAXIMUM CONSTRUCTED SLOPE OF 2.0%.
    - CONSTRUCTIONS SUCH AS SIGN POLES SHALL NOT BE PERMITTED WITHIN THE SIDEWALK.
    - LINEAR SLOPES, RAMP, ETC. SHALL COMPLY WITH CURRENT ADA STANDARDS.
    - SIDEWALK CONCRETE SHALL BE A MIN. 3000 PSI.
  - DRAINAGE DITCHES:**
    - ALL DRAINAGE DITCH SLOPES SHALL BE DESIGNED WITH A SLOPE OF 1 TO 4 (V TO H) EXCEPT AS NOTED BELOW.
    - DRAINAGE DITCH SHALL HAVE A MAXIMUM SLOPE OF 1 TO 2.5 (V TO H) WHEN 1 TO 4 CANNOT BE ACHIEVED DUE TO RIGHT-OF-WAY LIMITS.
    - DITCH BOTTOM WIDTH SHALL BE A MIN. 3 FEET WIDE UNLESS DESIGN CALCULATIONS REQUIRE WIDER.
  - UTILITY/DRAINAGE CUTS AND ROAD REPAIRS:**
    - MAXIMUM SIZE OF TEMPORARY REPAIR PATCHES WITHOUT MILL AND RESURFACE SHALL NOT EXCEED:
      - 7 FEET IN ANY DIRECTION, OR
      - 25 SQUARE FEET IN AREA.
    - WHEN THE PAVEMENT REPLACEMENT SIZE EXCEEDS 3A ABOVE, THE RECONSTRUCTION MAY BE DONE IN TWO PHASES:
      - PHASE 1: CUT PAVEMENT AT TRENCH WIDTH PLUS ONE FOOT EACH SIDE. COMPACT BACKFILL AND ROAD BASE: PATCH WITH ASPHALT.
      - PHASE 2: WITHIN 3 MONTHS (OR PRIOR TO END OF THE CURRENT PHASE OF DEVELOPMENT) MILL AND RESURFACE PER TECHNICAL DETAIL AND NOTES BELOW.
    - PAVED ROAD CUTS LESS THAN 100 FEET APART (CENTER TO CENTER) SHALL BE RESURFACED AS ONE.
    - A MAXIMUM OF FOUR (4) PAVEMENT CUTS WITHIN ANY 1,000 FOOT LENGTH IS PERMITTED WITHOUT FULL LENGTH RESURFACING. GREATER THAN FOUR CUTS WILL REQUIRE CONTINUOUS MILL AND RESURFACE FOR ALL TRAVEL LANES IMPACTED.
    - ANY PAVEMENT CUT GREATER THAN A PATCH SIZE NOTED IN 4.A ABOVE SHALL BE MILLED AND RESURFACED FOR THE FULL WIDTH OF THE TRAVEL LANE. (SEE UTILITY CUT DETAIL).
    - NO PAVEMENT SHALL BE ADDED TO EXISTING PAVEMENT WITHOUT A FULL RESURFACING OF THE TRAVEL LANE WHERE PAVEMENT IS ADDED.
    - TEMPORARY REPAIR PATCHES ARE PERMITTED AS NOTED ON THE "UTILITY/DRAINAGE CUT DETAIL" SHEETS PROVIDED THAT THE FINAL MILLING AND RESURFACING OF THE LANES IS COMPLETED WITHIN 3 MONTHS OF CONSTRUCTION.
    - REPLACE ALL PAVEMENT MARKINGS.
  - PAVEMENT MARKINGS AND TRAFFIC SIGNS SHALL COMPLY WITH CURRENT MUTCD AND FDOT STANDARDS. ALL SIGN PANELS SHALL UTILIZE 3MM REFLECTIVE SHEETING 3530 SERIES H/P INTENSITY OR 4090 SERIES D/G DIAMOND GRADE CURBED OR APPROVED EQUAL.**
  - ASPHALT MIX SHALL BE SUPERPAVE PER SECTION 334 (OR AS REVISED) FDOT STANDARDS.**
  - ROADWAY BASE AND SUB-BASE MATERIAL SHALL COMPLY WITH FDOT STANDARDS OR AS APPROVED BY SARASOTA COUNTY ENGINEER PRIOR TO PLANS APPROVAL.**
  - ALL ROADWAY AND ASSOCIATED ELEMENTS WITHIN THE RIGHT OF WAY SHALL BE DESIGNED AND CONSTRUCTED PER FDOT CURRENT STANDARDS AND SPECIFICATIONS EXCEPT AS NOTED WITHIN THIS COUNTY TECHNICAL STANDARD.**
  - NO WORK MAY BE PERFORMED IN COUNTY RIGHT OF WAY WITHOUT FIRST SECURING A COUNTY RIGHT OF WAY USE PERMIT. A TEMPORARY TRAFFIC CONTROL PLAN (TTCP) MUST ALSO BE SUBMITTED WITH DESIGN PLANS WHEN THE WORK IS WITHIN THE PAVEMENT OR SHOULDERS OF THE ROAD OR MAY DISRUPT TRAFFIC. A TTEP IS REQUIRED TO BE SUBMITTED TO THE COUNTY WITH OR WITHOUT CONSTRUCTION PLANS FOR OPEN CUTTING OF A ROAD. NO CONSTRUCTION MAY BE STARTED UNTIL THE TTCP IS APPROVED BY APPROPRIATE STAFF OF THE PUBLIC WORKS DEPT. OR PLANNING AND DEVELOPMENT SERVICES DEPT.**
  - ALL CONSTRUCTION WITHIN THE COUNTY RIGHT OF WAY SHALL BE DOCUMENTED WITH AS-BUILT DRAWINGS SIGNED AND SEALED BY A PROFESSIONAL ENGINEER OR SURVEYOR. AS-BUILT DRAWINGS DETAILS SHALL BE PER COUNTY STANDARDS. PRIVATE DRIVEWAYS, SIDEWALKS, BUS PADS AND OTHER MINOR ITEMS SHALL BE EXEMPT FROM THIS REQUIREMENT.**
  - ALL UTILITY RELATED WORK SHALL COMPLY WITH THE FDOT UTILITY ACCOMMODATION MANUAL (UAM) - CURRENT VERSION.**

Sarasota County  
**GENERAL NOTES**  
 UNIFIED DEVELOPMENT CODE  
 2 REV. DATE 07/10/2018

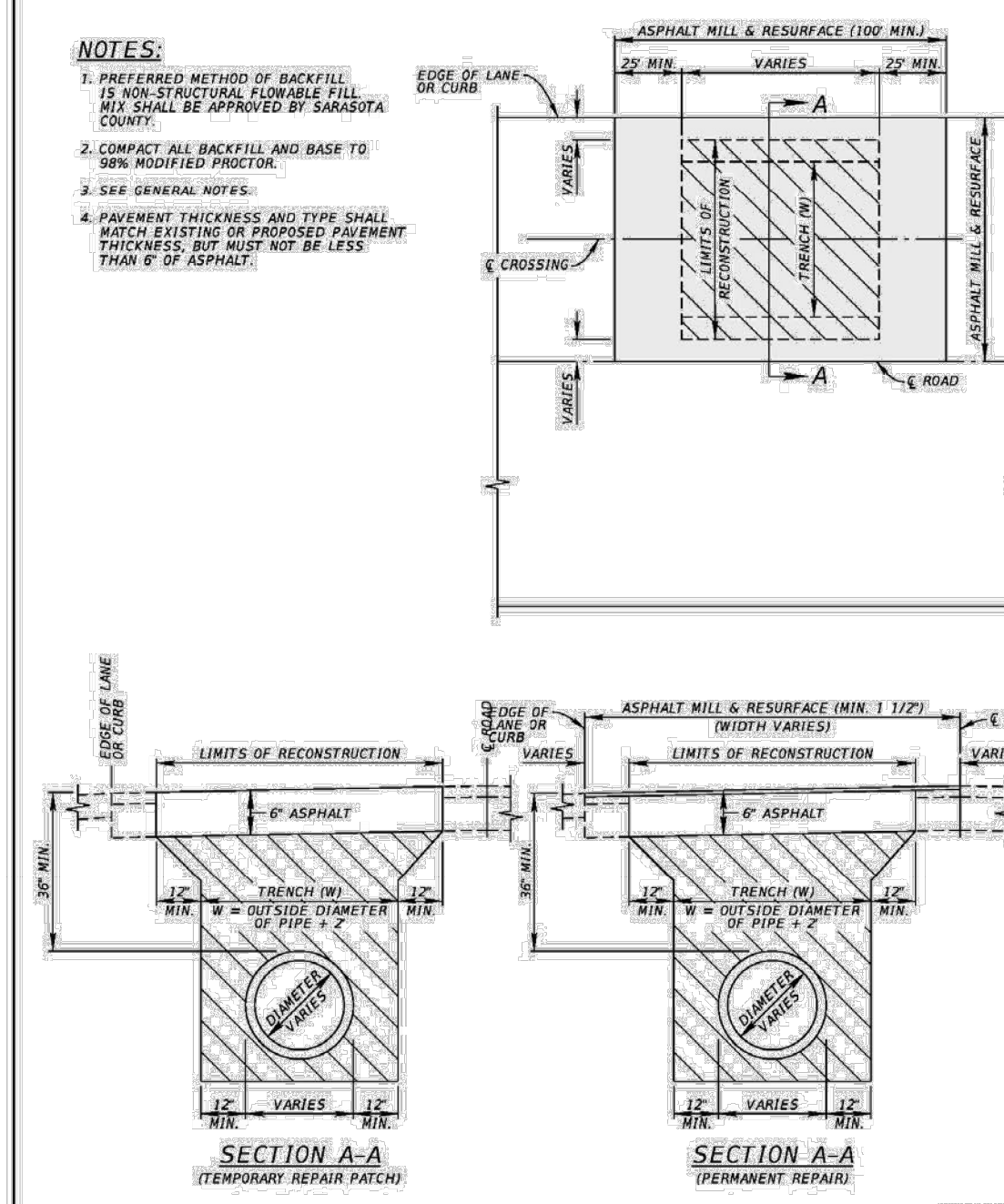

Sarasota County  
**UTILITY/DRAINAGE CUT DETAIL (LONGITUDINAL)**  
 UNIFIED DEVELOPMENT CODE  
 10 REV. DATE 07/10/2018

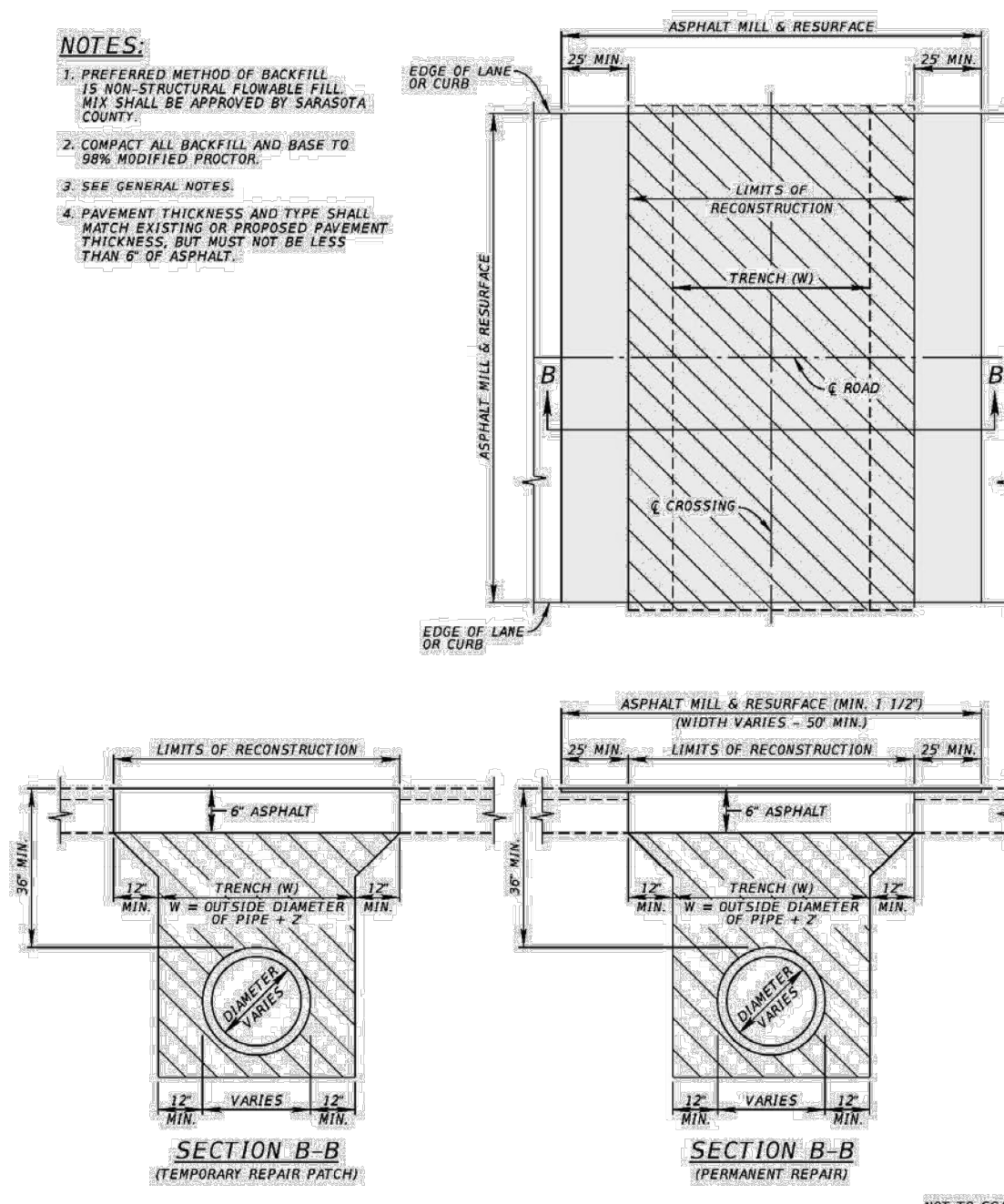

Sarasota County  
**UTILITY/DRAINAGE CUT DETAIL (TRANSVERSE)**  
 UNIFIED DEVELOPMENT CODE  
 11 REV. DATE 07/10/2018

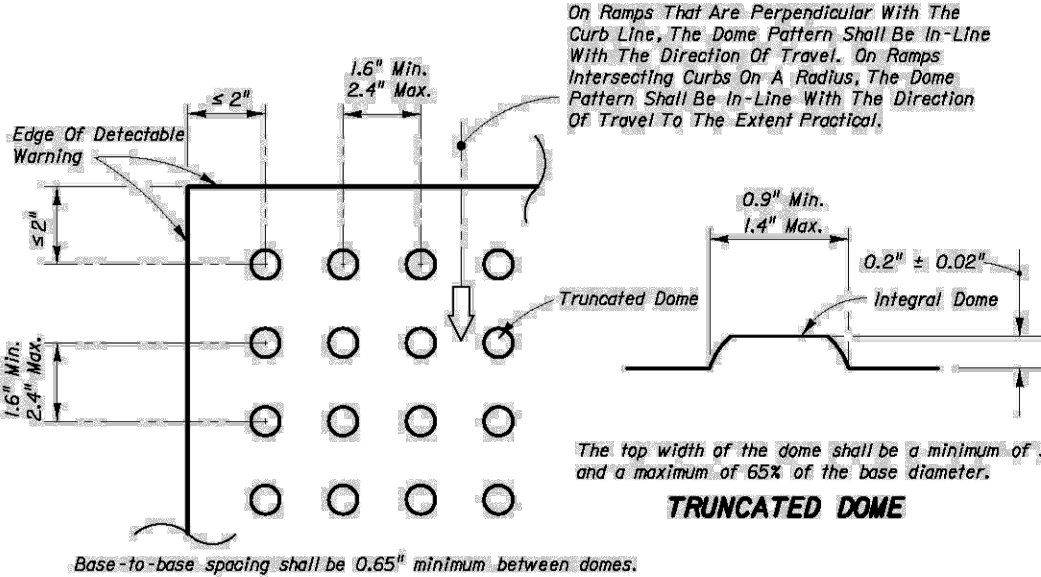

**CURB RAMP DETECTABLE WARNING DETAIL**

All Sidewalk Curb Ramps Shall Have Detectable Warning Surfaces That Extend The Full Width Of The Ramp And In The Direction Of Travel 24 Inches (610 mm) From The Back Of Curb.

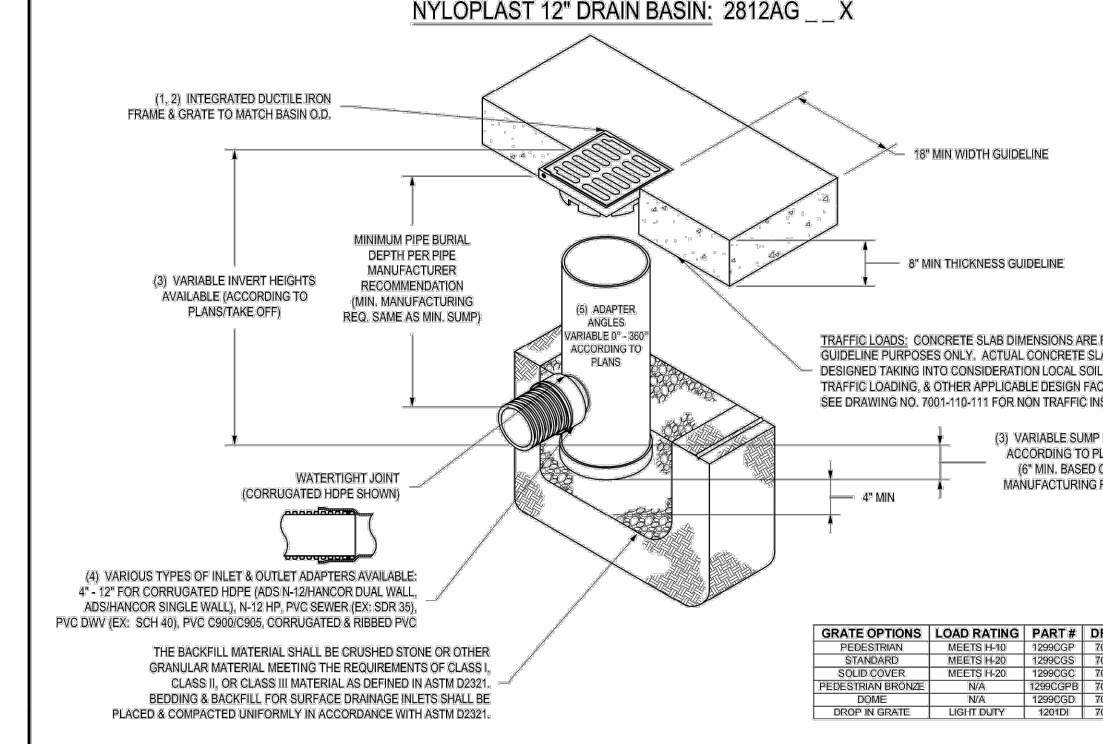

Sarasota County  
**NYLOPLAST 12" DRAIN BASIN: 2812AG...X**  
 UNIFIED DEVELOPMENT CODE  
 10 REV. DATE 07/10/2018

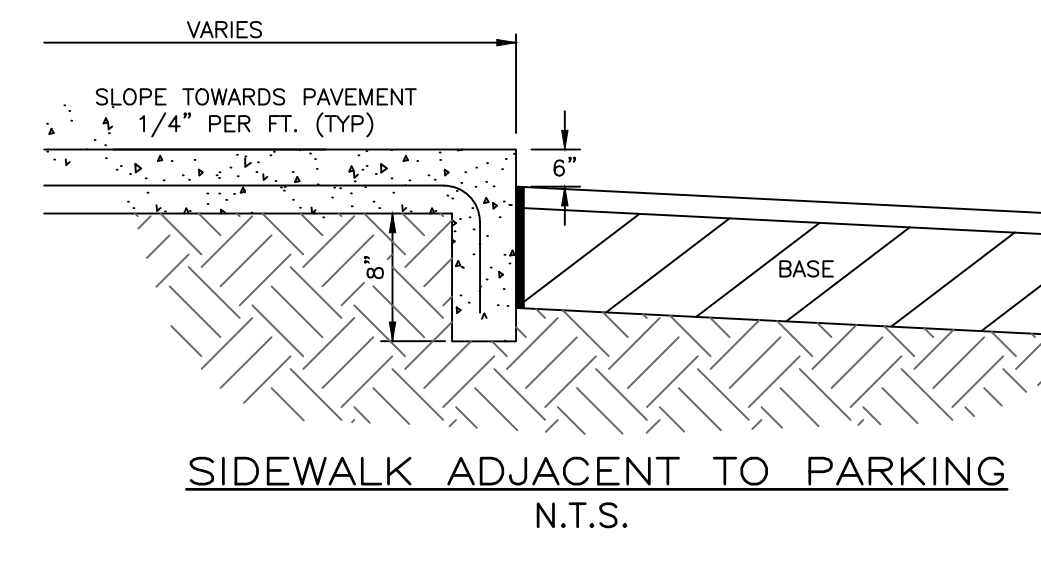

**SIDEWALK ADJACENT TO PARKING**  
 N.T.S.

ALL SPACES MUST BE LOCATED ON AN ACCESSIBLE ROUTE NO LESS THAN 44" WIDE SO THAT USER WILL NOT BE COMPELLED TO WALK OR WHEEL BEHIND PARKED CARS, AND SHALL BE LOCATED AS CLOSE TO MAIN ENTRANCE AS POSSIBLE

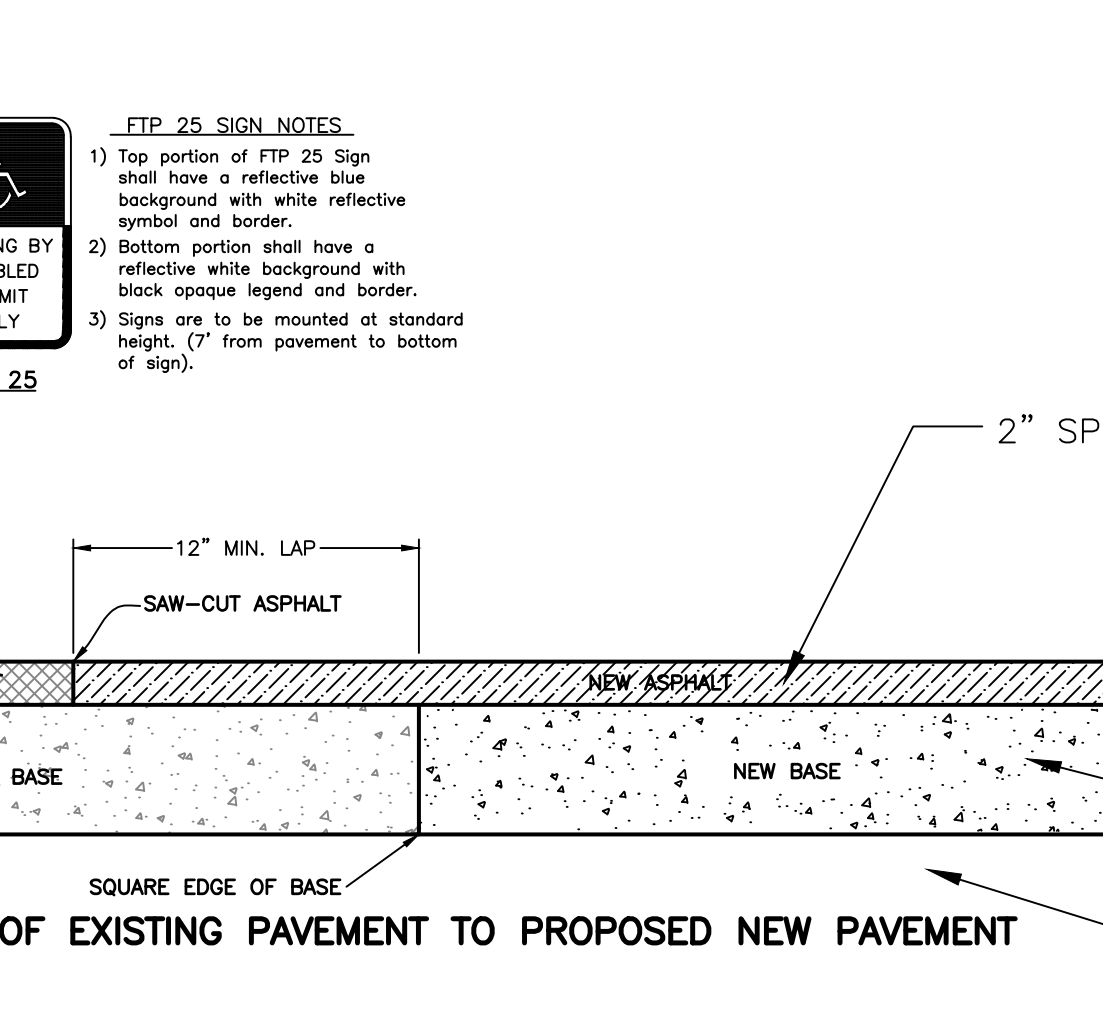

**CONNECTION OF EXISTING PAVEMENT TO PROPOSED NEW PAVEMENT**

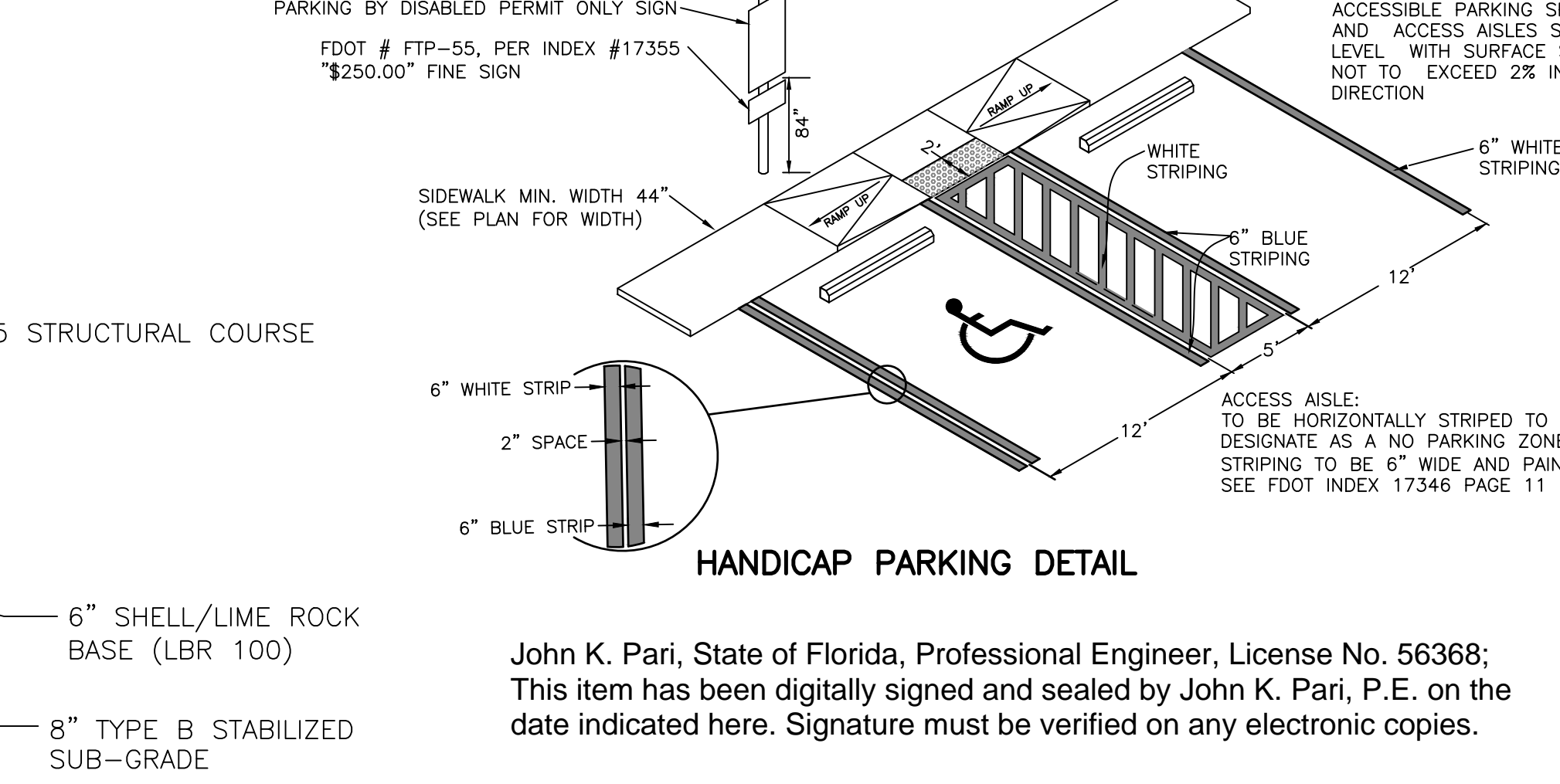

**HANDICAP PARKING DETAIL**

John K. Pari, State of Florida, Professional Engineer, License No. 56368; This item has been digitally signed and sealed by John K. Pari, P.E. on the date indicated here. Signature must be verified on any electronic copies.

REV. NO.	REV. DATE	REVISION DESCRIPTION	BY	REV. NO.	REV. DATE	REVISION DESCRIPTION	BY
1	10.17.25	ADDENDUM 01					

CALL BEFORE YOU DIG!  
 "SUNSHINE STATE ONE-CALL CENTER"  
 1-800-432-4770  
 THE CONTRACTOR SHALL NOTIFY "SUNSHINE STATE ONE-CALL CENTER" AND ALL OTHER UTILITIES FOR LOCATION OF EXISTING FACILITIES PRIOR TO BEGINNING CONSTRUCTION.  
 08/05/2025  
 CONSTRUCTION PLANS

**AM ENGINEERING, LLC.**  
 Civil Engineering | Land Surveying  
 8340 Consumer Court Sarasota, FL 34240  
 Phone: (941) 377-9178 | www.amengll.com  
 CA #33105 | LB #4334

DATE	08/05/2025
SCALE	AS SHOWN
SHEET	1 OF 4
DRAWN BY	AM
CHECKED BY	AM
DATE	08/05/2025
PROJECT NUMBER	1018
TITLE	1018 DRAIN BASIN QUICK SPEC INSTALLATION DETAIL
DRAWN BY	AM
SCALE	1/8" = 1'-0"
DRAWN BY	AM
DATE	08/05/2025

**STONEYBROOK GOLF & COUNTRY CLUB**  
**CLUBHOUSE- FITNESS CENTER RENOVATIONS, TENNIS CT. & NEW PICKLEBALL CT.**  
**PAVING, GRADING & DRAINAGE DETAILS**

HORIZONTAL SCALE	N/A
VERTICAL SCALE	N/A
VERTICAL DATUM	NTC
PROJECT NUMBER	STBR0001
SHEET NUMBER	7
DATE	08/05/2025
FLORIDA P.E. NO.	56368



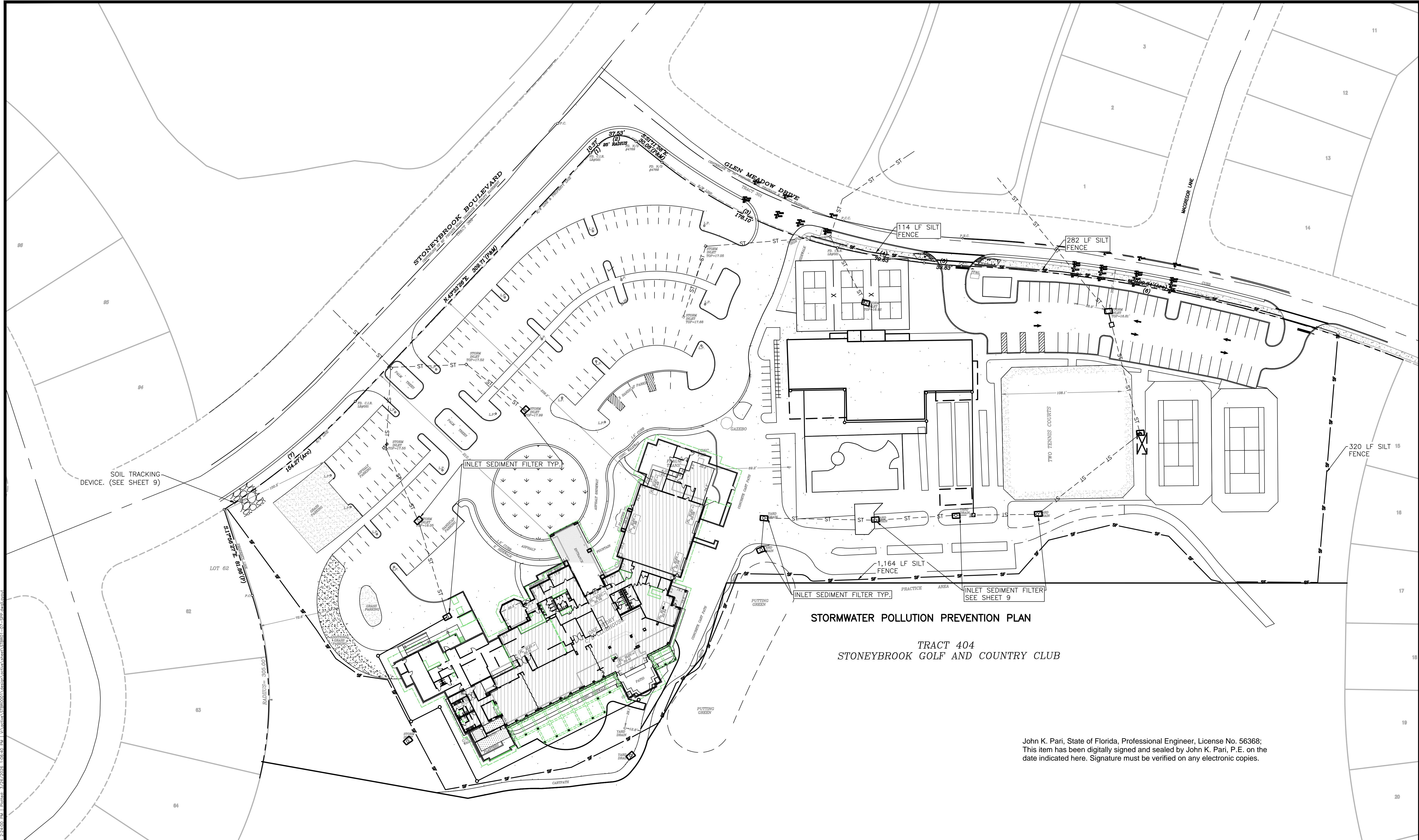

**STORMWATER POLLUTION PREVENTION PLAN**  
 TRACT 404  
 STONEYBROOK GOLF AND COUNTRY CLUB

John K. Pari, State of Florida, Professional Engineer, License No. 56368;  
 This item has been digitally signed and sealed by John K. Pari, P.E. on the  
 date indicated here. Signature must be verified on any electronic copies.

REV. No.	REV. DATE	REVISION DESCRIPTION	BY	REV. No.	REV. DATE	REVISION DESCRIPTION	BY
1	10.17.25	ADDENDUM 01					

CALL BEFORE YOU DIG!  
 "SUNSHINE STATE ONE-CALL CENTER"  
 1-800-432-4770  
 THE CONTRACTOR SHALL NOTIFY "SUNSHINE STATE ONE-CALL CENTER" AND ALL OTHER UTILITIES FOR LOCATION OF EXISTING FACILITIES PRIOR TO BEGINNING CONSTRUCTION.  
 ISSUE DATE: 8/05/2025  
 ISSUE DESCRIPTION: CONSTRUCTION PLANS  
 DRAWN BY: WP

Civil Engineering | Land Surveying  
**AM ENGINEERING, LLC.**  
 8340 Consumer Court Sarasota, FL 34240  
 Phone: (941) 377-9178 | www.amengfl.com  
 CA #33105 | LB #4334

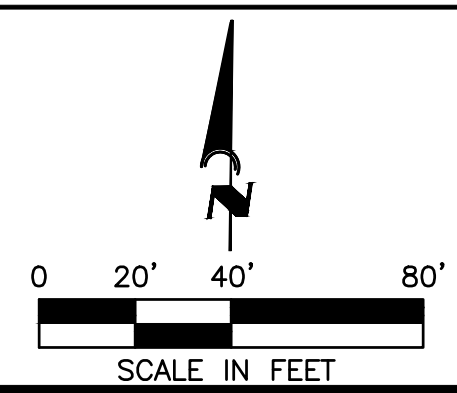

PROJECT: STONEYBROOK GOLF & COUNTRY CLUB  
 SUBJECT: CLUBHOUSE-FITNESS CENTER RENOVATIONS, TENNIS CT. & NEW PICKLEBALL CT.  
 DRAWING TITLE: STORMWATER POLLUTION PREVENTION PLAN

HORIZONTAL SCALE:	1"=40'
VERTICAL SCALE:	N/A
VERTICAL DATUM:	NGVD 29
PROJECT NUMBER:	STBR0001
SHEET NUMBER:	9

PROJECT ENGINEER:  
 JOHN K. PARI, PE  
 DATE: \_\_\_\_\_  
 FLORIDA P.E. No. 56368

**CONTRACTOR DEWATERING REQUIREMENTS:**

THE CONTRACTOR SHALL OBTAIN A COPY OF FDEP 62-621.300(2) PRIOR TO SUBMITTING A PROPOSAL FOR SERVICES TO THE OWNER. CONTRACTOR CAN OBTAIN A COPY OF THE FORM FROM THE ENGINEER OF RECORD (EOR). CONTRACTOR SHALL INCLUDE IN THEIR PROPOSAL FOR SERVICES ALL NECESSARY MONIES TO COMPLY WITH THE REQUIREMENTS OUTLINED IN 62-621.300(2).

DEWATERING MAY REQUIRE COVERAGE UNDER THE STATE GENERIC PERMIT FOR DISCHARGE OF PRODUCED GROUNDWATER FROM ANY NON-CONTAMINATED SITE ACTIVITY (FDEP 62-621.300(2)). IF SO, PERMIT COVERAGE SHALL BE OBTAINED PRIOR TO COMMENCEMENT OF DEWATERING.

ANY MAN-MADE PRODUCTION OF GROUND WATER TO BE DISCHARGED TO SURFACE WATER WOULD REQUIRE COVERAGE UNDER THE GENERAL PERMIT AS LONG AS THE SITE IS NOT CONTAMINATED. SEE FDEP DOCUMENT 62-621.300(2) FOR GUIDELINES FOR COVERAGE. A NOI WILL BE REQUIRED ONLY IF INITIAL TOC VALUES ARE ABOVE THE SCREENING VALUES AS LISTED IN THE FOLLOWING TABLE:

PARAMETER	SCREENING VALUES FOR DISCHARGE INTO:	
	FRESH WATERS	COASTAL WATERS
TOTAL ORGANIC CARBON (TOC)	10.0 mg/l	10.0 mg/l
PH, STANDARD UNITS	6.0-8.5	6.0-8.5
TOTAL RECOVERABLE MERCURY	0.012 ug/l	0.025 ug/l
TOTAL RECOVERABLE CADMIUM	9.3 ug/l	9.3 ug/l
TOTAL RECOVERABLE COPPER	2.9 ug/l	2.9 ug/l
TOTAL RECOVERABLE LEAD	0.03 mg/l	5.8 ug/l
TOTAL RECOVERABLE ZINC	86.0 ug/l	86.0 ug/l
TOTAL RECOVERABLE CHROMIUM (HEX)	11.0 ug/l	50.0 ug/l
BENZENE	1.0 ug/l	1.0 ug/l
NAPHTHALENE	100.0 ug/l	100.0 ug/l

**NPDES REQUIREMENTS:**

FEDERAL LAW PROHIBITS ALL POINT SOURCE DISCHARGE OR POLLUTANTS, WHICH INCLUDES THE DISCHARGE OF STORMWATER ASSOCIATED WITH LARGE (GREATER THAN 5 ACRES) CONSTRUCTION ACTIVITIES OR SMALL (LESS THAN 5 ACRES AND GREATER THAN 1 ACRES) CONSTRUCTION ACTIVITIES, TO WATERS OF THE UNITED STATES WITHOUT A NATIONAL POLLUTANT DISCHARGE ELIMINATION SYSTEM (NPDES) PERMIT. UNDER THE STATE OF FLORIDA'S AUTHORITY TO ADMINISTER THE NPDES STORMWATER PROGRAM, OPERATORS THAT HAVE STORMWATER DISCHARGE ASSOCIATED WITH LARGE OR SMALL CONSTRUCTION ACTIVITIES TO SURFACE WATERS OF THE STATE, INCLUDING THROUGH A MUNICIPAL SEWER STORM SEWER SYSTEM (MS4, I.E. TOWN, CITY OR COUNTY), SHALL OBTAIN COVERAGE EITHER UNDER A GENERIC PERMIT OR AN INDIVIDUAL PERMIT.

THE NPDES PERMIT REQUIRES INSPECTIONS ONE (1) TIME PER WEEK AND WITHIN 24 HOURS FOLLOWING A 0.5-INCH RAINFALL EVENT OF ALL BEST MANAGEMENT PRACTICES (BMP's) AND EROSION CONTROL MEASURES. AS AUTHORIZED BY THE OWNER, THE ENGINEER OF RECORD WILL MAKE PERIODIC INSPECTIONS AND DOCUMENT COMPLIANCE IN ACCORDANCE WITH THE NPDES PERMIT. HOWEVER, THE CONTRACTOR IS RESPONSIBLE FOR THE WEEKLY INSPECTIONS AND REQUIRED MAINTENANCE OF THE BMP'S AND EROSION CONTROL MEASURES AND THE POST-RAINFALL EVENT INSPECTIONS. THE INSPECTIONS MUST DOCUMENT COMPLIANCE WITH THE NPDES PERMIT OR CORRECTIVE ACTIONS NEEDED AND/OR TAKEN AND BE RECORDED ON THE STORMWATER POLLUTION PREVENTION PLAN INSPECTION REPORT FORM. THE CONTRACTOR CAN CONTACT FDEP AT 850-245-7522 OR VISIT THE FDEP WEBSITE AT WWW.DEP.STATE.FL.US FOR ADDITIONAL INFORMATION RELATING TO THE SWPPP AND THE NPDES PERMIT.

THE CONTRACTOR IS RESPONSIBLE TO OBTAIN A COPY OF THE STORMWATER POLLUTION PREVENTION PLAN (SWPPP) FROM THE ENGINEER OF RECORD (EOR) PRIOR TO SUBMITTING A CONSTRUCTION BID AND SHALL INCLUDE ALL MONIES NECESSARY TO ENSURE THAT THE SWPPP IS FOLLOWED DURING THE CONSTRUCTION DURATION. THE CONTRACTOR WILL BE REQUIRED TO COMPLY WITH ALL REQUIREMENTS OF THE SWPPP AND HAVE IT POSTED ON-SITE ALONG WITH THE EROSION CONTROL PLAN, THE NPDES PERMIT, AND THE COMPLETED INSPECTION REPORT FORMS. THE CONTRACTOR SHALL BE RESPONSIBLE FOR ALL EROSION CONTROL PRACTICES DEFINED IN THE SWPPP AND ASSOCIATED FINES THAT MAY BE IMPOSED BY THE FLORIDA DEPARTMENT OF ENVIRONMENTAL PROTECTION AGENCY (FDEP) FOR NOT COMPLYING WITH THE NPDES REQUIREMENTS CONTAINED IN THE SWPPP AND THE NPDES REGULATIONS. THE COSTS FOR COMPLYING WITH THE SWPPP AND THE NPDES PERMIT SHALL BE INCLUDED IN THE CONTRACTORS CONSTRUCTION BID.

**GENERAL NOTES**

- MEANS OF VEGETATION, EROSION AND SEDIMENT CONTROL WILL BE IMPLEMENTED AS DESCRIBED IN THE CONTROLS SECTION OF THE POLLUTION PREVENTION PLAN AND WILL BE MAINTAINED TO ENSURE THAT THEY ARE EFFECTIVE. IF ANY ADDITIONAL MEASURES ARE NEEDED, THEY WILL BE IMPLEMENTED PRIOR TO CONTINUING CONSTRUCTION ACTIVITIES.
- A QUALIFIED INSPECTOR (PROVIDED BY THE OPERATOR) SHALL INSPECT ALL POINTS OF DISCHARGE INTO SURFACE WATERS OF THE STATE OR AN MS4; DISTURBED AREAS OF THE CONSTRUCTION SITE THAT HAVE NOT BEEN FINALLY STABILIZED; AREAS USED FOR STORAGE OF MATERIAL THAT ARE EXPOSED TO PRECIPITATION; STRUCTURAL CONTROLS; AND, LOCATIONS WHERE VEHICLES ENTER OR EXIT THE SITE, AT LEAST ONCE EVERY SEVEN CALENDAR DAYS AND WITHIN 24 HOURS OF THE END OF A STORM THAT IS 0.50 INCHES OR GREATER.
- MAINTENANCE OF EROSION AND SILTATION CONTROL DEVICES: SILT FENCE, HAY BALES AND OTHER SILTATION AND EROSION CONTROL DEVICES SHALL BE INSPECTED DAILY BY THE CONTRACTOR DURING CONSTRUCTION. ANY INSTALLATION THAT HAS BEEN DAMAGED OR DISPLACED COMPONENTS, SHALL BE REPLACED OR REPAIRED IMMEDIATELY.
- MAINTENANCE OF EROSION AND SILTATION CONTROL DEVICES: DURING DEWATERING; PRIOR TO COMMENCING DEWATERING THE CONTRACTOR SHALL INSPECT THE TEMPORARY SEDIMENT, SUMP, SILT FENCE, HAY BALES AND OTHER COMPONENTS OF THE SILTATION AND EROSION CONTROL SYSTEM. DAMAGED OR DISPLACED COMPONENTS SHALL BE REPLACED OR REPAIRED PRIOR TO STARTING DEWATERING.

**EROSION AND SILTATION CONTROL:**

THE PROPOSED SILT FENCE WILL BE PLACED AT THE SITE PERIMETER PRIOR TO BEGINNING CLEARING OR DEMOLITION. THE SILT FENCE WILL REMAIN IN PLACE THROUGHOUT THE DURATION OF CONSTRUCTION WHICH IS ESTIMATED TO BE NINE MONTHS. ADDITIONAL EROSION CONTROL MEASURES SUCH AS FILTER CLOTH OVER INLET GRATES AND HAY BALES AT INLETS WILL BE IMPLEMENTED AS REQUIRED DURING CONSTRUCTION. FINAL STABILIZATION OF THE SITE WILL OCCUR AT THE END OF CONSTRUCTION WITH THE INSTALLATION OF THE LANDSCAPING. INTERIM STABILIZATION IN SELECT AREAS SUCH AS THE FILL SLOPE WILL BE IMPLEMENTED AS CONSTRUCTION ALLOWS.

A GRAVEL AREA LOCATED INSIDE THE PROPERTY AT THE CONSTRUCTION ENTRANCE WILL BE USED TO REDUCE SOIL TRACKING FROM THE SITE.

THE MAINTENANCE SCHEDULE FOR THE EROSION AND SILTATION CONTROL SYSTEM SHALL BE AS FOLLOWS:

- DAILY INSPECTION OF THE PERIMETER SILT FENCE FOR DAMAGE OR BREACHES. REPAIR AS NECESSARY.
- WEEKLY INSPECTION OF GRAVEL AREA AT CONSTRUCTION ENTRANCE. ADD GRAVEL AS REQUIRED TO MAINTAIN EFFECTIVENESS.
- STABILIZE SLOPES WITH SOD AS SOON AS FINISHED GRADING IS COMPLETE. WEEKLY INSPECTION OF SODDED SLOPES AND REPAIR OF ANY WASHOUTS OR ERODED AREAS.
- DAILY INSPECTION OF ADJOINING ROADWAY. SWEEP PAVEMENT AND GUTTERS AS REQUIRED TO REMOVE TRACKED SOIL.

SOLID WASTE INCLUDING CONSTRUCTION DEBRIS WILL BE PLACED IN ROLL ON CONTAINERS. IT IS ESTIMATED THAT THE DEBRIS WILL HAVE TO BE REMOVED AT ONE TO TWO WEEK INTERVALS DURING BUILDING CONSTRUCTION. SOLID WASTE MANAGEMENT, EROSION AND SILTATION CONTROL DEVICES SHALL BE INSTALLED, INSPECTED AND MAINTAINED BY THE GENERAL CONTRACTOR.

**POLLUTION PREVENTION NOTES**

- EROSION AND SEDIMENT CONTROL BMP'S IN ADDITION TO THOSE PRESENTED ON THE PLANS AND OUTLINED IN THE EROSION AND SEDIMENT CONTROL PLAN (ECP), BEST MANAGEMENT PRACTICES (BMP) PLAN, OR STORMWATER POLLUTION PREVENTION PLAN (SWPPP) SHALL BE IMPLEMENTED AS NECESSARY TO PREVENT TURBID DISCHARGES FROM FLOWING ONTO ADJACENT PROPERTIES OR ROADWAYS, OFF SITE STORMWATER CONVEYANCES OR RECEIVING WATERS, OR ON SITE WETLANDS AND SURFACE WATERS. BMP'S SHALL BE DESIGNED, INSTALLED, AND MAINTAINED BY THE SITE OPERATOR TO ENSURE THAT OFF SITE SURFACE WATER QUALITY REMAINS CONSISTENT WITH STATE AND LOCAL REGULATIONS. [THE OPERATOR IS THE ENTITY THAT OWNS OR OPERATES THE CONSTRUCTION ACTIVITY AND HAS AUTHORITY TO CONTROL THOSE ACTIVITIES AT THE PROJECT NECESSARY TO ENSURE COMPLIANCE.]
- OFF SITE SURFACE WATER DISCHARGES, DISCHARGES TO THE MS4, OR DISCHARGES TO ONSITE WETLANDS OR SURFACE WATERS WITH TURBIDITY IN EXCESS OF 29 NEPHELOMETRIC TURBIDITY UNITS (NTUS) ABOVE BACKGROUND LEVEL SHALL BE IMMEDIATELY CORRECTED. SUCH INCIDENTS SHALL BE REPORTED TO SARASOTA COUNTY WITHIN 24 HOURS OF THE OCCURRENCE (PH: 941.861.5000; EMAIL: REPORTPOLLUTION@SCGOV.NET). THE REPORT SHALL INCLUDE THE CAUSE OF THE DISCHARGE AND CORRECTIVE ACTIONS TAKEN.
- THE OPERATOR SHALL ENSURE THAT ADJACENT PROPERTIES ARE NOT IMPACTED BY WIND EROSION, OR EMISSIONS OF UNCONFINED PARTICULATE MATTER IN ACCORDANCE WITH RULE 62-296.320(4)(C), F.A.C., BY TAKING APPROPRIATE MEASURES TO STABILIZE AFFECTED AREAS.
- FUEL AND OTHER PETROLEUM PRODUCT SPILLS THAT ENTER STORMWATER DRAINS OR WATERBODIES, OR FUEL AND OTHER PETROLEUM PRODUCT SPILLS THAT ARE IN EXCESS OF 25 GALLONS SHALL BE CONTAINED, CLEANED UP, AND IMMEDIATELY REPORTED TO SARASOTA COUNTY (PH: 941.861.5000; EMAIL: REPORTPOLLUTION@SCGOV.NET). SMALLER GROUND SURFACE SPILLS SHALL BE CLEANED UP AS SOON AS PRACTICAL.
- IF PREVIOUSLY UNKNOWN RECOGNIZED ENVIRONMENTAL CONDITIONS (E.G. CONTAMINATED SOIL AND/OR GROUNDWATER, BURIED WASTES, ETC.) ARE DISCOVERED DURING DEVELOPMENT OF THE SITE, ALL ACTIVITY IN THE IMMEDIATE VICINITY SHALL CEASE, AND SARASOTA COUNTY SHALL BE CONTACTED (PH: 941.861.5000; EMAIL: REPORTPOLLUTION@SCGOV.NET).
- PRIOR TO RENOVATION OR DEMOLITION OF EXISTING ON-SITE STRUCTURES AN ASBESTOS SURVEY AND/OR ASBESTOS NOTIFICATION MAY BE REQUIRED. FERTILIZER APPLICATION SHALL BE CONSISTENT WITH CHAPTER 54, ARTICLE XXIII (FERTILIZER AND LANDSCAPE MANAGEMENT) OF THE SARASOTA COUNTY CODE.
- NATIONAL POLLUTANT DISCHARGE ELIMINATION SYSTEM - STORMWATER: NPDES CONSTRUCTION GENERIC PERMIT COVERAGE SHALL BE OBTAINED AT LEAST 48 HOURS IN ADVANCE OF CONSTRUCTION COMMENCEMENT IN ACCORDANCE WITH THE REQUIREMENTS OF THE NATIONAL POLLUTANT DISCHARGE ELIMINATION SYSTEM (NPDES) GENERIC PERMIT FOR STORMWATER DISCHARGE FROM LARGE AND SMALL CONSTRUCTION ACTIVITIES (AKA CONSTRUCTION GENERIC PERMIT, OR CGP).
- A COPY OF THE CERTIFIED NPDES NOI, OR A COPY OF THE FDEP COVERAGE CONFIRMATION LETTER SHALL BE POSTED AT THE SITE IN ACCORDANCE WITH PART 2.6 OF THE GENERIC PERMIT, AND AS PER SEC 54-187(G)(1) OF THE SARASOTA COUNTY CODE.
- COPY OF THE CERTIFIED NPDES NOI, OR A COPY OF THE FDEP COVERAGE CONFIRMATION LETTER SHALL BE PROVIDED TO SARASOTA COUNTY WITHIN 7 CALENDAR DAYS IN ACCORDANCE WITH PART 2.6 OF THE GENERIC PERMIT, AND SEC. 54-187(G)(1) OF THE SARASOTA COUNTY CODE.
- THE SWPPP SHALL BE CERTIFIED IN ACCORDANCE WITH PART 4.6 OF THE GENERIC PERMIT, AND A COPY OF THE CERTIFIED DOCUMENT SHALL BE SUBMITTED TO SARASOTA COUNTY AT LEAST 48 HOURS PRIOR TO THE COMMENCEMENT OF CONSTRUCTION PER SEC 54-187(G)(1) OF THE SARASOTA COUNTY CODE.
- A COPY OF THE SWPPP, AND COPIES OF THE INSPECTION AND MAINTENANCE RECORDS SHALL BE MAINTAINED AT THE PROJECT SITE, AND SHALL BE READILY AVAILABLE TO COUNTY OR STATE INSPECTORS PER SEC 54-187(G)(1) OF THE SARASOTA COUNTY CODE.
- NATIONAL POLLUTANT DISCHARGE ELIMINATION SYSTEM - DEWATERING: IF NOT OTHERWISE COVERED AS OUTLINED UNDER PART 3.4 OF THE GENERIC PERMIT, THE DISCHARGE OF GROUNDWATER PRODUCED THROUGH DEWATERING, TO SURFACE WATERS, OR TO ANY PORTION OF THE MS4 WILL REQUIRE SEPARATE PERMITTING FROM THE FLORIDA DEPARTMENT OF ENVIRONMENTAL PROTECTION (DEP). PERMIT(S) SHALL BE OBTAINED PRIOR TO THE COMMENCEMENT OF DEWATERING. ANALYTICAL RESULTS FROM PRE-DISCHARGE TESTING SHALL BE PROVIDED TO SARASOTA COUNTY PURSUANT TO CHAPTER 54, ARTICLE VII (WATER POLLUTION CONTROL) OF THE COUNTY CODE.

**SWPPP SEQUENCE OF EVENTS**

- SURVEYORS STAKEOUT SILT SCREEN LOCATION
- SILT SCREEN INSTALLED
- CLEARING AND GRUBBING OPERATIONS
- REPAIR ALL SILT SCREEN DAMAGED DURING CLEARING AND GRUBBING
- CONSTRUCT SEDIMENTATION BASINS FOR DEWATERING
- EARTH MOVING-CONSTRUCT LAKES, FILL LOTS, ROADS, SWALES, AND BERMS
- FINAL GRADING OF SLOPES
- INSTALL SWALES OR BERMS TO PROTECT SLOPES
- SOD SLOPES
- BMP'S TO BE MAINTAINED THROUGHOUT ALL CONSTRUCTION ON THE SITE
- MAINTENANCE AND INSPECTIONS

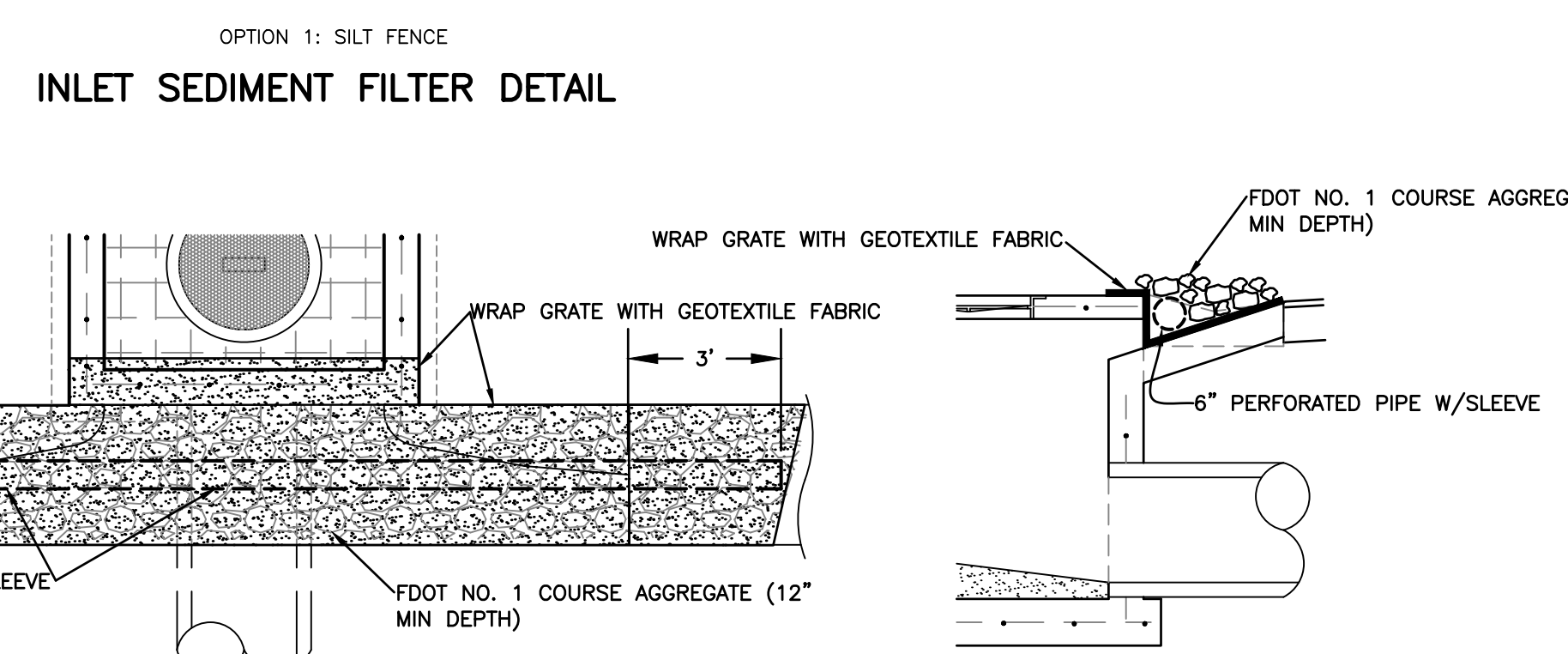
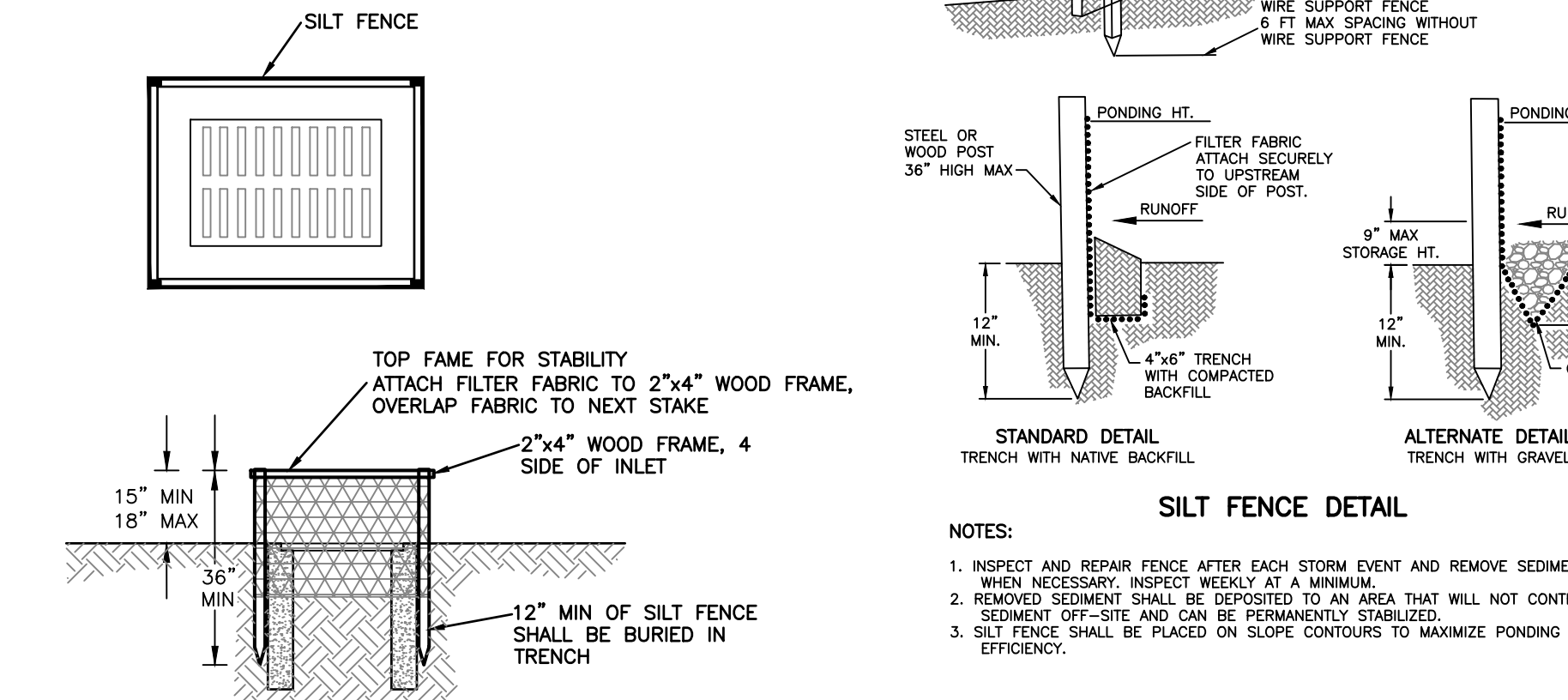
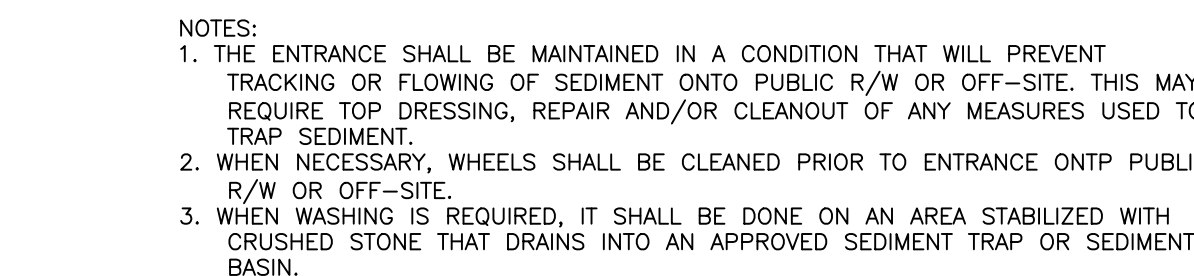
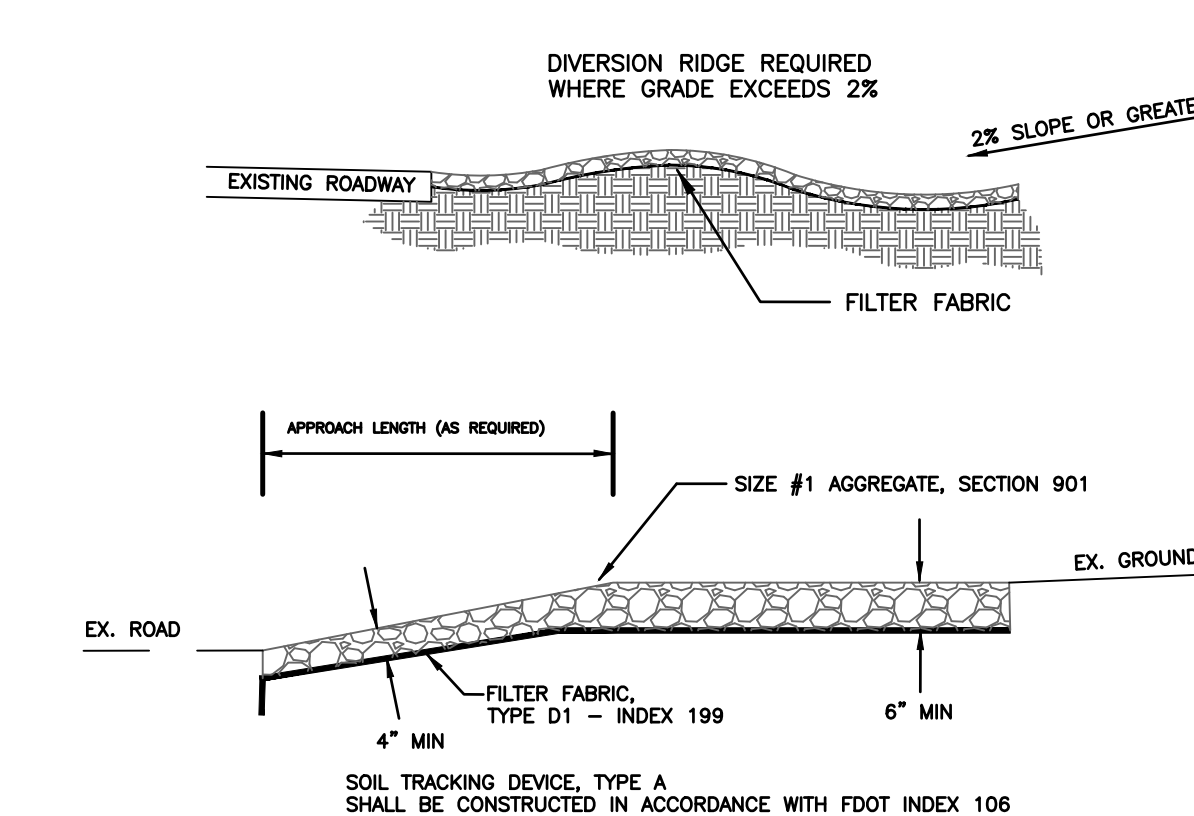
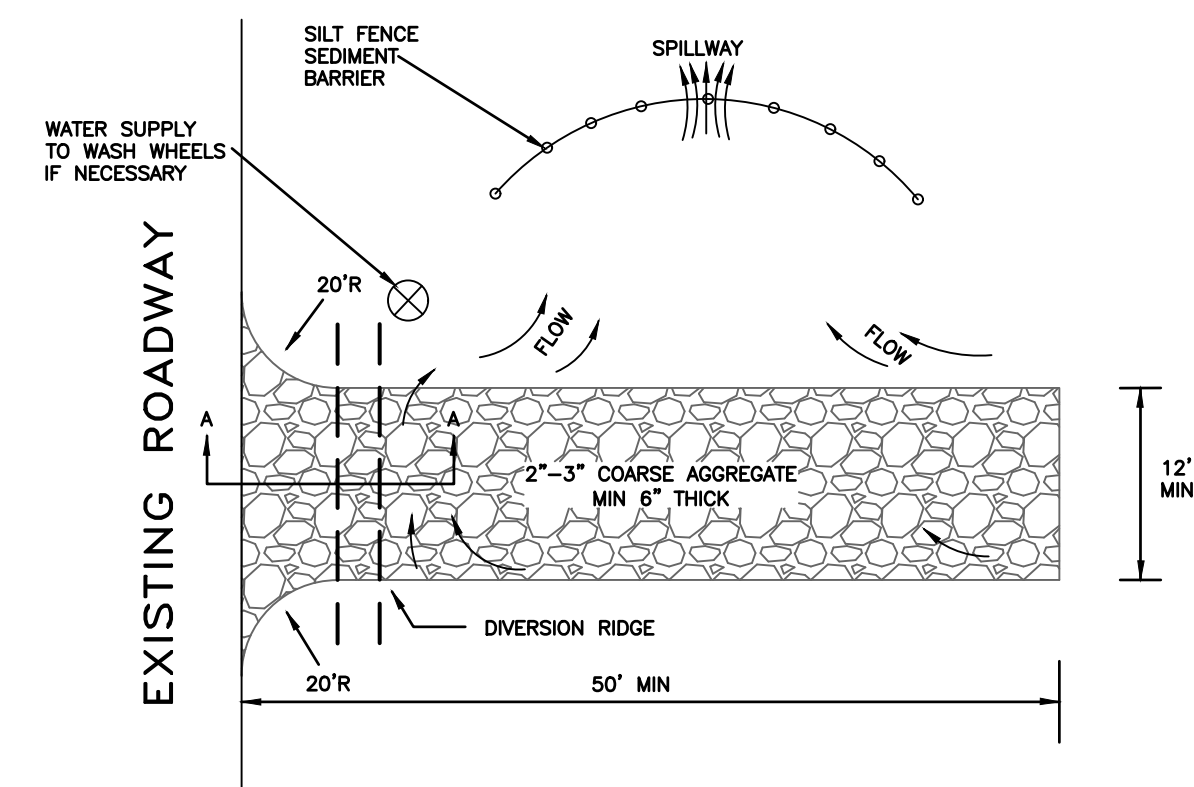
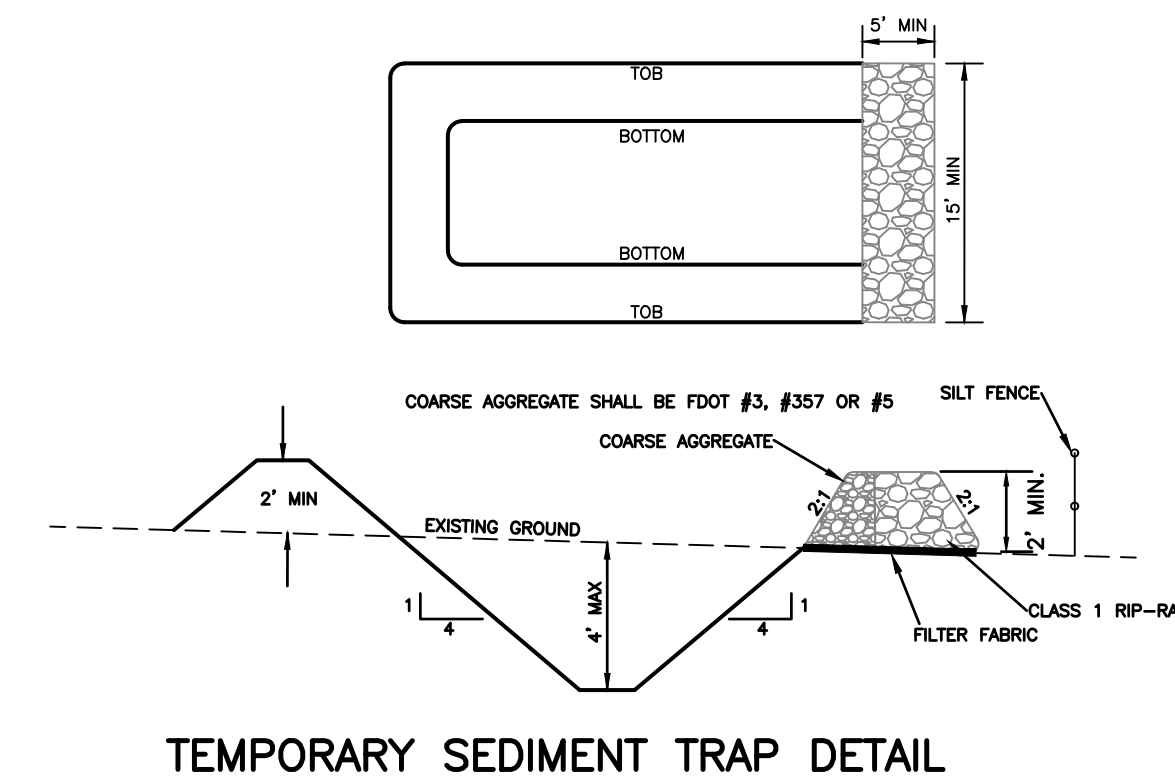

John K. Pari, State of Florida, Professional Engineer, License No. 56368; This item has been digitally signed and sealed by John K. Pari, P.E. on the date indicated here. Signature must be verified on any electronic copies.

REV. NO.	REV. DATE	REVISION DESCRIPTION	BY	REV. NO.	REV. DATE	REVISION DESCRIPTION	BY
1	10.17.25	ADDENDUM 01					

CALL BEFORE YOU DIG!  
 "SUNSHINE STATE ONE-CALL CENTER"  
 1-800-432-4770  
 THE CONTRACTOR SHALL NOTIFY "SUNSHINE STATE ONE-CALL CENTER" AND ALL OTHER UTILITIES FOR LOCATION OF EXISTING FACILITIES PRIOR TO BEGINNING CONSTRUCTION.  
 ISSUE DATE: 8/05/2025  
 ISSUE DESCRIPTION: CONSTRUCTION PLANS

**AM ENGINEERING, LLC.**  
 Civil Engineering | Land Surveying  
 8340 Consumer Court Sarasota, FL 34240  
 Phone: (941) 377-9178 | www.amengll.com  
 CA #33105 | LB #4334

PROJECT: STONEYBROOK GOLF & COUNTRY CLUB  
 SUBJECT: CLUBHOUSE- FITNESS CENTER RENOVATIONS, TENNIS CT. & NEW PICKLEBALL CT.  
 PROJECT NUMBER: STBR0001  
 SHEET NUMBER: 10

PROJECT ENGINEER: JOHN K. PARI, PE  
 DATE: 10/17/25  
 FLORIDA P.E. No. 56368